

**TRANSMATIX**

# PLANETARY CREEP DRIVES



Manufactured & Marketed by :

**TRANSMATIX**

**Admn. Off.:** 106, Parth C.H.S.Ltd., Ganesh Peth Lane, Dadar (West), Mumbai – 400 028.  
Tel.:/Fax : (022) 24376004, 24227887 Tel.: (022) 30900255  
E-mail ID : [satishdharap@vsnl.com](mailto:satishdharap@vsnl.com), [satishdharap@mtnl.net.in](mailto:satishdharap@mtnl.net.in)

**Regd. Off.:** 8, Govind Sadan, Shivaji Park Road No.4, Dadar (West), Mumbai – 400 028.  
Tel.: (022) 24449606, 30901436.

**Works :** W-24, Old M.I.D.C., Satara – 415 004.  
Tel.:/Fax : (0262) 248151 Tel.: (0262) 320751

## • INTRODUCTION

TRANSMATIX, a leading manufacturer of Planetary Gear Drives, has come out with specially designed Planetary Creep Drives for overhead cranes. TRANSMATIX MAKE Planetary Creep Drives has a nominal ratio of 10 : 1 and are ideal for getting positive creep speed for full load. All the gears are made from proper grades of alloy steels and hardened. The foot brackets and housings are made of cast steel.

## • WORKING PRINCIPLE

The input shaft of the Creep Drive is connected to the creep motor and the output shaft is connected to the main motor. The complete creep gear box is free to rotate on bearings which are fitted in foot pedestals. The shoe brake is fitted on the base and is applied on the outside diameter of the ring gear. In normal running, the brakes are open, main motor is running and creep motor is stationary. In creep mode, the creep motor is running, the main motor is off and the brakes are on.

SELECTION TABLE (For 1000 rpm Input)				
MODEL	CR 160	CR 200	CR 250	CR 300
MAX. I/P POWER in H.P.*	2	3	5	8

\*(The above ratings are based on one hour continuous duty)

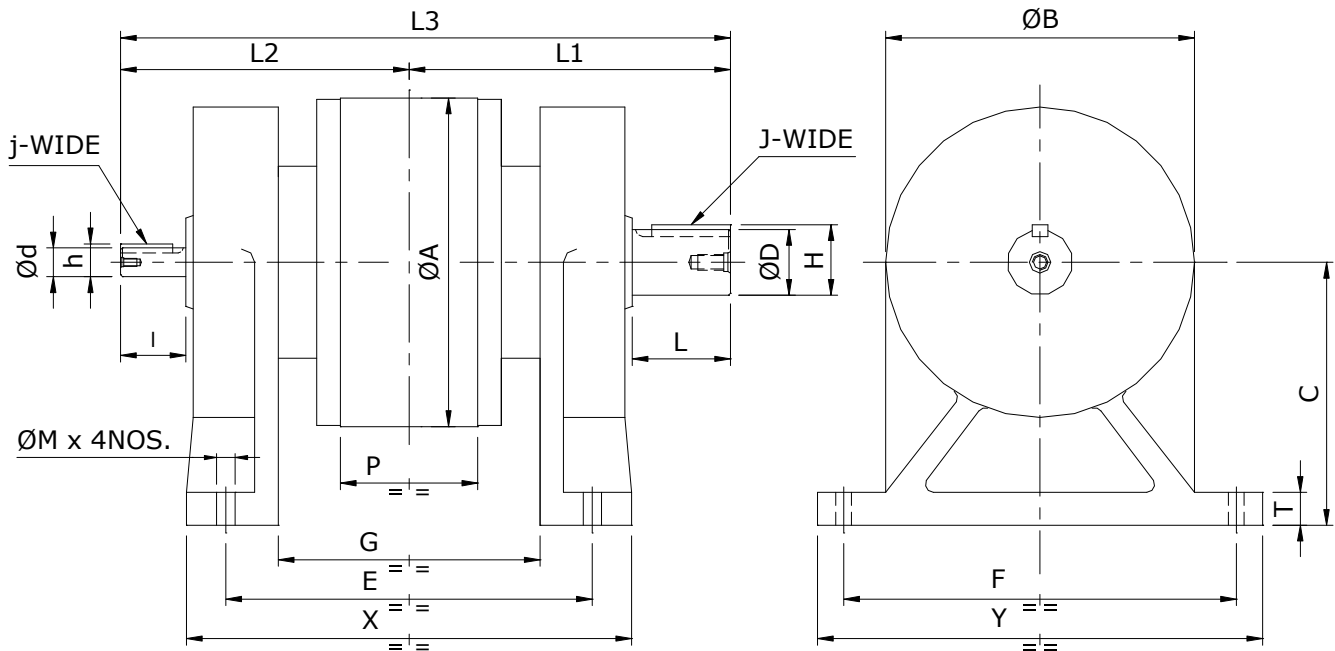

## DIMENSION CHART

Model	Output Shaft					Inout Shaft					Foot Mounting								Overall			
	j6 D	H	p9 J	L	L1	j6 d	H	p9 i	I	L2	C	G	X	Y	E	F	T	B	M	A	P	L3
CR 160	28	31	8	42	164	19	21.5	6	30	152	125	132	250	220	215	180	15	170	12	160	70	316
CR 200	38	41	10	55	191	24	27	8	40	176	200	157	262	220	222	180	20	170	14	200	95	367
CR 250	50	53.5	14	75	245	28	31	8	50	220	225	200	340	360	280	320	25	236	14	250	105	465
CR 300	60	64	18	85	275	38	41	10	55	245	275	240	380	360	320	320	25	236	18	300	145	520